



The Open Door

BETHEL PRESBYTERIAN CHURCH / MARCH 2009

Bethel Presbyterian Church
203 S. Kentucky Street
Kingston, TN 37763

To contact us:

Phone: (865) 376-6340
Fax: (865) 376-6390
Email: lbethel@bellsouth.net
On the web: www.bethelpcusa.org

Sunday Schedule:

9:45 a.m. Sunday School for all ages
11:00 a.m. Worship
6:00 p.m. Youth
Sacrament of Holy Communion is celebrated
on the first Sunday of each month.

*Bethel Presbyterian Church —
a community of
faith, fellowship,
study and
service...seeking
God's peace, justice
and love.*



Dear Bethel Congregation:

I'm so excited about re-entering our new building I can hardly stand it! The carpet will go down early this week, with the pews soon to follow. If all goes according to plan, looks like mid-March will be our first service back "home." There'll be all kinds of celebrating going on once we're back, but in a wonderful gesture that lets Bethel's priorities be known, the session authorized us to share in the sacrament of holy communion our first Sunday back – a sign of solidarity, our call to ministry, the joy of fellowship, and reaching out to others. We have some folks who've patiently been waiting to join our congregation once we got back, so we will have the joy of welcoming others into our midst early on in our time back. It's going to be awesome!

We are very blessed indeed, not just by outstanding lay leadership, but by the return of Rev. Pat Harvey and her husband Jerry into our midst. My oncologists recommended that I return to disability status, which the session has graciously approved. Pat will step into the pastoral role, and we all know how extensive are her gifts for ministry and her joy and enthusiasm for the people and future of Bethel. Our Parish Nurse, Debbie, will of course continue her outstanding ministry of care and helping.

I can't begin to express how much your love, prayers, and support have sustained me and my family – the special healing service, the cards and calls, your willingness to do so much "extra" around the church in this time of transition and excited expectation. As I am able, I look forward to being involved in the many festivities and celebrations of Bethel's new building and the hope for our future that it represents.

In Christ's Love,
Marc Sherrod, Minister

If you are interested in becoming a member of Bethel once we return to our new church, please make a note on the blue Fellowship Folder, call the church office [376.6340] or contact one of the Presbyterian pastors.

The Open Door

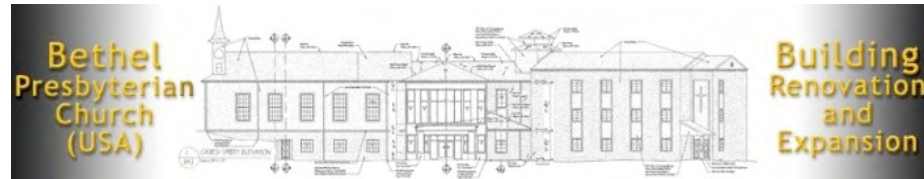

A note from Pat:

HOW DID BETHEL'S BEAUTIFUL NEW BUILDING COME ABOUT?
GOOD QUESTION!

On January 8, 2003, Bethel Presbyterian Church in Kingston, Tennessee embarked on an adventure called "A Season of Dreaming". This process assisted Bethel in developing a six-year mission plan. We discovered a clear Biblical understanding of vision and its role in the mission of the church. We also gained a clearer understanding of how mission relates to specific ministries and programs. But, most importantly, we developed a greater commitment to Bethel's vision and mission for the future.

The tangible result of this process was a new Vision Statement and plans for the future. Little did we know that once we came to recognize the sources of our congregation's unique character and inspirations, we would be faced with the challenge of TRANSFORMATION (spiritual and physical). Christ had something new to say to us and to the world!

After 190 years – we were so bold to ask "What was God's desire for us now?" I remember those first meetings of "A Season of Dreaming". It seemed to me (of course...Jerry and I had just moved to town), but from eyes that were not steeped in the wonderfully rich traditions of Bethel...we sensed there were some at Bethel who were somewhat

ambivalent about growth. Yet, all the people gathered together in this place we call Bethel truly desired what God desires – to reach out to our community and world with Christ's love and compassion. Without a doubt, growth would go hand in hand with that desire to move into the future. We were ready to move forward – but there were barriers blocking our path forward.

We tried to listen to God's voice in one another, in structured demographic studies, supplemented by interviews with a full array of community leaders. We kept asking the question: "What are the needs of the community?" This process opened our hearts to our neighbors in a renewed way – allowing the needs of the community to break through.

I remember hearing of a man at Bethel who had a handicapped child and envisioned a school which became Michael Dunn Industries! Bethel was there to meet the needs of that ministry! And now we were hearing that folks wanted to insure that the strong presence of Christ through the ministry of Bethel Church would always be here in Kingston... even when they were gone!

We were painfully aware of the need to update our historic wooden structure (whose foundation was literally crumbling beneath us). There were physical barriers as well. The physical inaccessibility of our church was a hindrance to visitors and members as well. We actually had people visit that saw Bethel as a friendly and welcoming church but there

were many concerned with safety and accessibility issues.

During that "Season of Dreaming" it was obvious that we needed a safe church and facility with space for young and old, youth, Boy Scouts, Head Start and a place that could be open and welcoming to the community. A place where "unchurched" people in



our community would feel welcomed...a safe place for all.

*God placed that dream in our hearts...
and those dreams were put on paper...*

*Two successful building campaigns later...
Construction began!*

And our historic sanctuary was moved...

A Note from Pat (continued)

Which bring us to this day...and what is God doing in our midst!

In Katy Banker's wonderful book *A Church Called Bethel*, Katy wrote that the Bethel Church Session minutes of April 6, 1887 state: "It appearing that on Sabbath morning, the 27th day of March, 1887, that Bethel Church, which had been rebuilt on a new site, was rededicated by Rev. D. L. Lander, of Chattanooga, Tennessee..."

In June of 2008 the same sanctuary that was moved in the 1800's was successfully moved again onto her new basement and connected to the educational wing by an incredibly beautiful addition. This new multi-level narthex is truly a gathering place for all. The entire church is now accessible to everyone, with the addition of an elevator and handicap accessible restrooms. The whole church has been transformed - with the amazing union of the old historic sanctuary that was moved from Presbyterian Hill in the 1880's!

Because of a series of delays (which almost all construction projects have) we were not back into our church by Christmas of 2008 as hoped. The delays have made the target date for our first service March 22, 2009. With the formal re-rededication to be March 29, 2009 (120 years plus two days) from the last Bethel re-dedicated! It seems to me... quite providential!

*Bethel Presbyterian Church (USA)
...a community of faith coming together for
worship, fellowship, study and service, seeking
God's peace, justice and love...*

will be "re-rededicated"

Sunday afternoon,

March 29, 2009 at 3:00 PM

Thanks be to God!

This time of celebration will include our brothers and sisters from Kingston United Methodist Church - who have opened their hearts and doors to us, sheltered from the heat of the summer and cold of the winter... and who have loved us unconditionally! We will also thank the many people who have made the seasoning of dreaming a reality... from our architect, construction company, Kingston City Officials...the list goes on! Please save this day to thank these dear ones and to thank God for guiding us in "A Season of Dreaming..."

- March 22 9:45 Sunday School
 11:00 AM Worship*
- March 29 9:45 Sunday School
 11 AM Worship
 3:00 PM Re-rededication
 of Bethel Presbyterian
 Church
 Open House and Reception*

Coming In April

Seder Dinner-April 8th

The Seder is an experience conducted with elements that are both historical and ritual, with symbolic foods, scripture and hymns. We will share the elements of the Passover table which is both a memorial of the deliverance from the Jewish bondage of slavery in Egypt, and a prophecy of the coming Messiah. The Jews wait for their Messiah, while we as Christians look for the second coming of our Lord and Savior Jesus Christ. This Seder will help prepare us for the trials of Holy Week and the joy of the Resurrection! *Reservation by March 15.*

Maundy Thursday -April 9

WORSHIP 6:30 P.M.

Good Friday - April 10

WORSHIP 6:30 P.M.



*Children's Easter
Celebration*

Saturday, April 11 - 9:00

*Sponsored by KUMC/BETHEL YOUTH
Adults \$3.00 - Children under 12 \$5.00 -
Family max \$15.00
Pancake Breakfast - Crafts - Photos w/Bunny -
Easter Story - Egg Hunt*

Easter - April 12

EASTER WORSHIP

An Introduction to Lent

Lent has begun – and we just celebrated its beginning the day before Ash Wednesday ("Fat Tuesday"). Fat Tuesday has developed into a time of "partying and carousing", exemplified by the extravagant celebration in New Orleans. Most people who celebrate Mardi Gras attach little or no religious significance to it. Yet, it is a time to prepare for the forty days of Lent, and to ponder the trials of Holy Week and to look forward to the joy of Christ's resurrection on Easter SEE The Presbyterian Worship Sourcebook (pages 551-552):

The death and resurrection of Jesus Christ are at the heart of the Christian gospel, and Good Friday and Easter are two of the most significant celebrations of the Christian year...Good Friday... filled with pain, grief and terror. Followed by a day filled with hope and grace! HOPE OUT OF CHAOS! Lent is a season of preparation and repentance during which we anticipate Good Friday and Easter.

Just as we carefully prepare for big events in our personal lives, such as a wedding or graduations, Lent invites us to make our hearts ready for remembering Jesus' passion and celebrating Jesus' glorious resurrection.

The practice of a forty-day preparation period began in the Christian church during the third and fourth centuries. The number forty carries biblical significance based on the forty years Israel spent in the wilderness and Jesus' forty-day fast in the wilderness.

The forty days of Lent begin on Ash Wednesday and continue through Holy Week, not counting Sundays (which are reserved for celebratory worship). In practice, many congregations choose to focus Sunday worship on the themes of repentance and renewal.

As a period of preparation, Lent has historically included the instruction of persons for baptism and profession of faith on Easter Sunday; the calling back of those who have become estranged from the church...and from God; and efforts by all Christians to deepen their devotion, and readiness to mark the death and resurrection of their Savior. So the primary focus of the season is to explore and deepen a "baptismal spirituality" that centers on our union with Christ rather than to function only as an extended meditation on Christ's suffering and death. The traditional color for the season is purple...as is signified with the changed paraments.

March Mission Outreach Activities

- 3/8 ETFOGS (Grace School) Meeting contact: Joe Coen 7:00 pm at 1st Presbyterian Church, Knoxville
3/12 MO Committee Meeting contact: Joe Coen 7:00 pm at KUMC Annex
3/13 Angel Food March orders due to United Way contact: Jane Walsh
3/21 Angel Food distribution for March contact: Jane Walsh
3/29 5th Sunday Worship at MCRCF contact: Karen Schall

From the Parish Nurse

For those of us that are mission-minded, there are many opportunities to serve coming up in spring and summer. First of all, there is May 2-May 9th trip to Long Beach Mississippi. We have a limit to only 30 people going on this trip and cost per person is \$100.00. This includes food but does not include transportation down there. If you would like to go, please contact Deb Hyder at 376- 6340 and I will make sure your name gets put on the list. As this will be an adults-only trip (school will not be out yet), the work will be more skilled. Our Kingston United Methodist neighbors are very welcome to join us! As the time for the trip nears we will meet and plan for transportation and fine-tune our tool list.

The Kingston United Methodist/ Bethel Presbyterian Youth are planning a joint mission project this summer on the week of June 14- 21st. The week will begin at New Smyrna Presbyterian Church in Conyers, Georgia. From Sunday through Thursday the youth will stay at this church that was originally built like our John Knox Center. They will stay in cabins and be taken to their job site by co-coordinators each morning after having a hot breakfast. There is an Olympic size pool and basketball and baseball areas to relax in at night after work. Lunch is sent to the job site with the workers and a hot supper is provided at night. Work consists of assisting the elderly of the community with home repairs. On Thursday, the youth will relocate to the United Methodist Children's Home in Macon, Georgia. This children's home was established in 1872 and has served over 10,000 children over the 135 years it has been in operation. Youth are asked to please reserve this week on your summer calendar- I think you will find it a very rewarding week. Please see Regina Little for cost and to sign up. As always, to your health.....Deb

2009 Roane State

Health Fair

Wednesday, March 11 8AM – 12:00 N
Roane State Community College Student Lounge
Free health screenings include: blood pressure, bone density, vision, carotid artery ultrasound, heart rhythm, mammography** and more!
CBC (complete blood count) : \$ 15.00
PSA (prostate specific antigen): 20.00
TSH (thyroid stimulating hormone): 20.00
C-RP (high sensitivity C-reactive protein): 20.00

For more info call (865) 882.4679 or (865) 541.4500

**mammogram appointments are required and space is limited. Insurance will be filed, or cost is \$103 for self pay.

Cents-Ability Offerings at Work in 2009

This month's Presbytery newsletter announces that Roane County Cooperative Ministries, Kingston received a \$1,000 grant from the Presbyterian Hunger Program's Cents-Ability (formerly 2 Cents a Meal) program. It will go to R.C.C.M.'s Garden Project and will enable forty families to obtain seeds, plants, and fertilizer to grow food in their own gardens. Surplus produce is shared with family and neighbors. For more information, go to Bethel's website: www.bethelpcusa.org/mnrnc04.html



Prison Ministry

Bethel's Ministry to the inmates at Morgan County Regional Prison continues in March with three activities scheduled. On Thursday, March 5th and Tuesday, March 24th, we have been asked to provide desserts for the banquets given by the members of the Varsity Club and the Veteran's Club for their families and guests. These banquets are a way for the inmates to show their appreciation to their families and friends who care for them while they are incarcerated. The inmates pay for the meal with their dues, and Bethel provides wonderful desserts, which they surely don't get very often! If you would like to help by providing a dessert for either of these events, please contact Karen Schall (423-369-2955 or schallk@highland.net) and we'll arrange to pick up your dessert.

Also, on Sunday evening, March 29th, Bethel's prison ministry team, along with folks from KUMC and Westminster Presbyterian, will go to the prison to conduct worship with the inmates. If you are interested in attending, please contact Karen to get your name on the list.

Youth News

PET High School Youth Summit
March 6-8, 2009

Live in the G+A+P (Grace, Acceptance, Peace)
Ezekiel 22:30
Location: Glenstone Lodge, Gatlinburg, TN
Keynote Speaker: Mark DeVries

Cookie News: Gift of Caring cookie boxes from Girl Scout Troop 846 will be delivered to Jamestowne and Wellington Assisted Living facilities in mid-March. Thank you for your donations. Cookie boxes for your family order will be available on Sunday, March 8. Julie will contact you about pickup. Please call 376-9033 for other details.

One Great Hour of Sharing began sixty years ago in the aftermath of World War II. A radio broadcast heard across the United States one Saturday night asked citizens to place generous donations in their churches' collection plates the next morning to relieve the devastating effects of WWII upon the world.

The PC(USA) offering is divided between the Presbyterian Hunger Program, Presbyterian Disaster Assistance, and Self-Development of People.

This special offering helps our most vulnerable brothers and sisters across the globe whose needs are increasing, and it shows God's love in a powerful and tangible way that makes a difference in the lives of so many people.

Further information about OGHS can be found at www.pcusa.org/oghs or by contacting Alan Krome at alan.krome@pcusa.org (888-728-7228 ext. 5168).

Camp John Knox

Work Day, March 28 at Camp John Knox
Join us for a day of fellowship and the giving of your time. You provide the manpower and tools - we provide the lunch, snacks, and ice cold water. Come as a group or on your own. This is a perfect project for Sunday School Groups, Men's Groups, Ladies' Groups, Mission Groups and more. Help our maintenance staff get a good start for 2009. Building renovations, trail maintenance, landscaping, log cutting and cleanup are a few of the areas of need. Project assignments begin at 8 am in the front parking lot. Just call the office at (865) 376-2236 to register your group.

Did You Know? Bethel has a total of 169 family and individual members and 22 have promised to contribute monthly to help pay our mortgage?

Spring Hike in April

Hold the date of Sunday afternoon, April 26 on your calendars for the next all-church hike. We'll gather a group of Bethel and KUMC folks that day – look for details to come in next month's Open Door. Contact Mark Banker (376-2118) or Joe Coen (376-9033) for more information.

Environmental Stewardship/Green Team

Many of us are getting ready to start planting outside which means many plastic pots will have to be dealt with. Most of these containers can be recycled. The Michael Dunn Center can take any with the recycling logo and the numbers 1 – 7. The recycling center at Midtown can take the black plastic containers. The little four-pack and six-pack containers cannot be recycled but can be either reused for give aways or crumpled up and placed in the bottom of large pots for drainage and to fill in volume. Please contact Jane B. Walsh at pwalsh8372@bellsouth.net or call 376-5250 if you would like help in recycling these containers. Also, please note that the Michael Dunn Center is now accepting tin cans.

Notes and Letters

A big hug and thank you to all my Bethel and Kingston United Methodist friends for their prayers, cards, food, visits and love during my recent surgery. I am now in a state of recovery and feeling better every day. God Bless!
Warmest Thanks, Bonnie Anderson

Thank you to Bethel Knitters

Dear Jill,

Thank you and the other members of Bethel Presbyterian Church who made the attractive knitted toboggan caps to give to the "needy" children at Christmas. I appreciated so much your help. Sincerely, Jean Springer, Second Presbyterian Church.

Congratulations!

Seventh-grader Julie placed third in the 4H regional speech competition this February. Her topic was the leadership of President James Madison.



The members and regularly attending friends of Bethel are assigned to elder care groups. Each month, we publish the list of one or more elder care groups in the newsletter for your prayers. The elder's name and phone at the top of the list are listed as a reminder of their role in nurturing and supporting those who belong to Bethel. You should feel free to contact your elder or the pastor if you have a particular spiritual need or other matter that needs to be brought to our attention.

JAN RYBKA (2011) 882-8836

Alfred, John (Out-of-State)
Allen, *Chuck & Cathy
Cantrell, Charlie
Cantrell, Sara
Dice, Don & Jean
Gilliam, Carolyn McNew
Hayes, John
*Harmon, Melanie
*Kehner, Laura
Knies, Amanda Phillips & *Adam
Maddux, *Aaron & +Kelly Shadden
McElhinney, Mike & Jeanette
*Phillips, Bonnie
-Pierce, Gene
+Pierce, Janice
+Pierce, Kathy
Preston, Mark & Linda, -Corey, Ryan
Richmond, Roger & Anita,
John, Chelsea, Jesse (out of state)
Shadden, Bill & Marianne
Smith, Anne
Stevenson, Dave & Helen

Memorial Gifts

In memory of Bryan Walker from Gary and Dianne Griffith
In memory of Madge Benfield from Gary and Dianne Griffith
In memory of Bruce Murr from Gary and Dianne Griffith
In memory of Mary Lee McGill from Gary and Dianne Griffith, Frank and Marilyn Harris, Dick Evans and Celia Simon, James and Georgia Cooley, Gilbert and Linda Pickel, Hubert and Estle Blaylock, Jackie and Barbara Jackson, J.D. and June Williams

JAMES WOODARD (2011) 376-4497

Marlene, Jamie
Anderson, Bonnie
Davis, *Sam & Joan*
Hettrick, Marge & Dick*
Hettrick, Teresa
Holloway, Danny & Tammy, Andy
McDowell, Cathy & Dan
Morris, Jerry & Jennie
Robbins, Mac
Robbins, *Charity & *Terry
Roostee, ^Helen
+Tipton, Linda Jo Templeton

*non-member
^shut-in
+inactive
-baptized roll

March 2009

1	2	3	4	5	6	7
			No Handbell Practice	MCRCX Banquet 5:00	PET Youth Summit Mar. 6-8	
8	9	10	11	12	13	14
	Christian Ed	Parish Life	Roane State Health Fair	Mission Outreach 7:00		
15	16	17	18	19	20	21
			P&P 5:30 Family Supper 6:30			
22	23	24	25	26	27	28
Welcome Home to Bethel!		MCRCX Banquet 5:00			Book Discussion Group 1:30	Workday @ Canmp John Knox
29	30	31	EACH WEEK: Seniorcize M-W-F 9:00 AM Handbell Practice: Wed., 5:30 Choir Practice: Wed. 7:00 Spanish: Mon., 6:00, Wed., 7:00			
Dedication of Sanctuary & Reception 3:00						

Remember to pray for:

Assisted Living and Nursing Homes

Jamestowne
 851 Lawnville Road, Kingston 37763
 Nelle Griffith Room 206
 Louise Pickel Room 209
 Mac Robbins Room 305
 Anne Smith Room 312
 Wellington Place
 1098 Bradford Way, Kingston 37763
 Jan Parker Room 107
 Marge Maki Room 308
 Baptist Healthcare
 700 Williams Ferry Rd 45 Lenior City 37771
 Evelyn Waldrup Room 42A
 The Bridge at Rockwood
 5580 Roane State Hwy Rockwood 37854
 Roberta Cash Room 201B
 Gene Pierce Room 209
 Margaret True Room 212B
 Harriman Healthcare
 240 Hannah Rd Harriman 37748
 Ruby Hunter Room 305A
 Joan Pemberton Room 205B
 NHC Healthcare Oak Ridge
 300 Laboratory Rd Oak Ridge 37830
 Wanda Carter Room 212A
 NHC Healthcare,
 2120 Highland Ave., Knoxville 37916
 Barbara Baird Room 115A
 Greenfield Senior Living
 360 Laboratory Rd Oak Ridge 37830
 Doris Barber Room 229/231

March Birthdays

2 Dianne Griffith
 Bina Kirby
 Ginny Warlick
 Jean Young
 3 Duie Swicegood
 5 Vic King
 Dan McDowell
 Robert Winsbro

8 Charlie Coen
 9 Kathy Banker
 11 Margaret True
 12 Libby Cuneo
 13 Linda Choate
 Gary Griffith
 14 Travis Brown
 Shawn Hart

16 Wanda Carter
 17 Hayden Jacks
 Paul Pearman
 19 Marge Hettrick
 26 Justin Murr
 27 Greg Murr
 28 Peggy Sheppard
 29 Nancy King

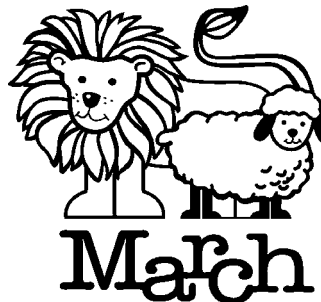

Home

Dot and Al Davis, Fern Stackpole, Glenda True
 Everett, Betty Baird Brown, Lucy Webb, Barbara
 Baird, Bonnie Anderson, Bill Martin, Nelda Toon,
 Kay Michener, Marc Sherrod, Jason Brown (in
 Germany).

Staff

Minister: Rev. Marc Sherrod, ThD
Pastor Emeritus: Dr. Richard Hettrick
Parish Associate:
Rev. Pat Harvey
Administrative Assistant: Sandra R. Tallant
Parish Nurse: Debbie Hyder
Choir Director: Laura Walker
Bell Choir Director: Chris Badger
Treasurers:
Disbursement: Linda Brown
Receipts: Larry Strickling
Nursery Worker: Linda Gerth
Custodian: John Carter

Session

2009

Carol Brown
Joe Coen
Joni Morgan
Gary Griffith
2010

Steve Jacks
Bobbie Martin
Margaret Murr
Phil Walsh
2011

Mary B Hines
Jeremiah Jacks
Jan Rybka
James Woodard
Clerk: Cathy McDowell

Website Editor:

Danny Holloway
danhollo@aol.com

Newsletter Editor:

Karen Schall
schallk@highland.net
(423) 369-2955

Bethel Presbyterian Church
203 S. Kentucky Street
Kingston, TN 37763

U.S. Postage Paid
Non-Profit Organization
Permit #2
Kingston, Tennessee

March 2009

The Open Door

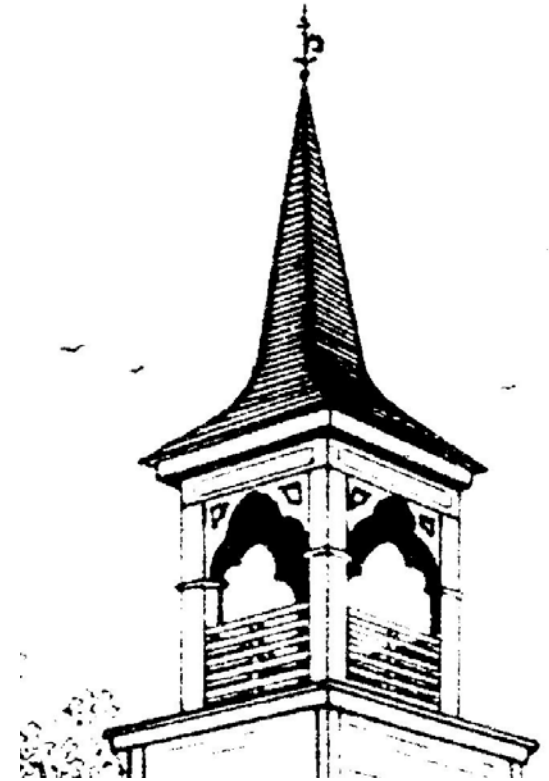

BETHEL PRESBYTERIAN CHURCH
MARCH 2009 / VOL. 6, ISSUE 3